

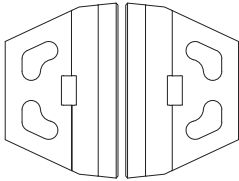

# SKYSCRAPER

DESCRIPTION: Wall TEXTURE: Smooth

## Pallet Overview - Top unit



## Pallet Overview - Middle unit

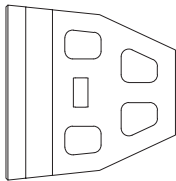

## Pallet Overview - Corner unit

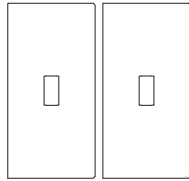

Smooth

Chestnut Brown



Smooth

Shale Grey

### TOP UNIT

#### Specifications per pallet

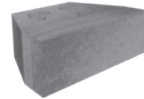

4 units / pallet

	Imperial	Metric
Dimension Front (L x D x H)	36 x 23 1/4 x 12	914 x 590 x 305
Dimension Back (L x D x H)	20 3/8 x 23 1/4 x 12	513 x 590 x 305
Cubing	12.00 ft <sup>2</sup>	1.11 m <sup>2</sup>
	12.00 lin ft	3.66 lin m
Approx. Weight	2 100 lbs	953 kg
Number of rows	2	
Coverage per row	6.00 ft <sup>2</sup>	0.56 m <sup>2</sup>
Linear coverage per row	6.00 lin ft	1.83 lin m

### MIDDLE UNIT

#### Specifications per pallet



2 units / pallet

	Imperial	Metric
Dimension Front (L x D x H)	36 x 34 7/8 x 12	914 x 886 x 305
Dimension Back (L x D x H)	17 1/2 x 34 7/8 x 12	444 x 886 x 305
Cubing	6.00 ft <sup>2</sup>	0.56 m <sup>2</sup>
	6.00 lin ft	1.83 lin m
Approx. Weight	1 620 lbs	735 kg
Number of rows	2	
Coverage per row	3.00 ft <sup>2</sup>	0.28 m <sup>2</sup>
Linear coverage per row	3.00 lin ft	0.91 lin m

### CORNER UNIT

#### Specifications per pallet



4 units / pallet

	Imperial	Metric
Product dimension (L x D x H)	36 x 18 x 12	914 x 457 x 305
Cubing	4 units	4 units
Approx. Weight	2 460 lbs	1 116 kg
Number of rows	2	

## NOTES

See page 6 for icons description.

### COMPATIBLE CAPS

See page 145 for product compatibility.

Clamp or Mechanical tool available for machine installation. Check with your local Techo-Bloc representative for more information.

See page 146 to 161 for more technical information.



# SKYSCRAPER

DESCRIPTION: Wall TEXTURE: Smooth

## BASE UNIT

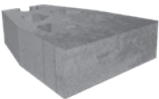
Specifications per pallet		Imperial	Metric
	Dimension Front (L x D x H)	36 x 48 1/8 x 12	914 x 1220 x 305
	Dimension Back (L x D x H)	17 5/8 x 48 1/8 x 12	440 x 1220 x 305
2 units / pallet	Cubing	6.00 ft <sup>2</sup>	0.56 m <sup>2</sup>
		6.00 lin ft	1.83 lin m
	Approx. Weight	1 860 lbs	844 kg
	Number of rows	2	
	Coverage per row	3.00 ft <sup>2</sup>	0.28 m <sup>2</sup>
	Linear coverage per row	3.00 lin ft	0.91 lin m

## EXTENDER UNIT

Specifications per pallet		Imperial	Metric
	Product dimension (L x D x H)	20 1/2 x 24 3/8 x 12	520 x 619 x 305
	Cubing	4 units	4 units
4 units / pallet	Approx. Weight	1 800 lbs	816 kg
	Number of rows	2	

## Pallet Overview - Base unit

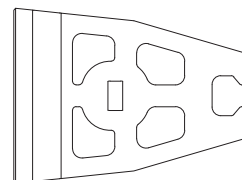

## Pallet Overview - Extender unit

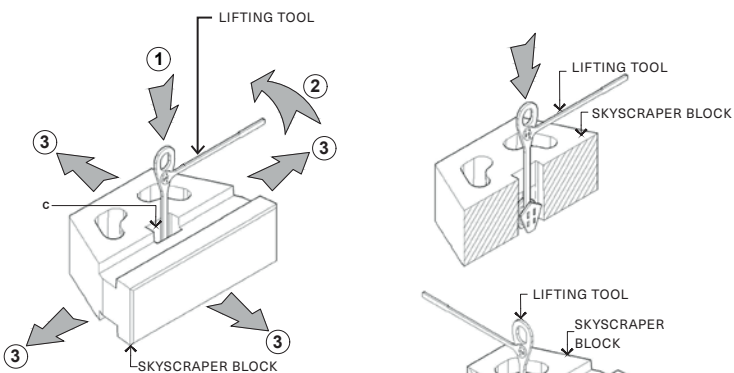
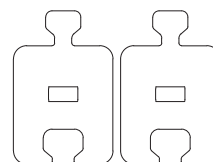

NOTE:  
 1. INSERT TECO-BLOC LIFTING TOOL INTO THE LIFTING CAVITY.  
 2. TURN THE LIFTING TOOL TO LOCK THE SYSTEM.  
 3. MOVE AND INSTALL BLOCK AS REQUIRED.  
 4. USE EQUIPMENT AND RIGGING CONFORMING TO LOCAL CODES AND CAPABLE OF LIFTING EACH UNIT WEIGHT.

Chestnut Brown

Smooth



Shale Grey

Smooth



## NOTES

See page 6 for icons description.

### COMPATIBLE CAPS

See page 145 for product compatibility.

See page 146 to 161 for more technical information.

### ALLOWABLE STRESS DESIGN

CLEAN SAND/ SAND AND GRAVEL MIXES ( $\phi=34^\circ$ ,  $\gamma = 130$  pcf)

**CASE N° 1 :**  
No Surcharge  
No Backslope  
No Toe Slope

**5 ft (1.52 m) Total Height**  
T: 5

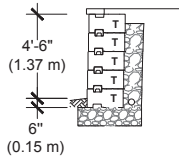

**6 ft (1.83 m) Total Height**  
T: 5  
M: 1

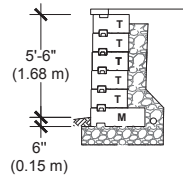

**7 ft (2.13 m) Total Height**  
T: 5  
M: 2

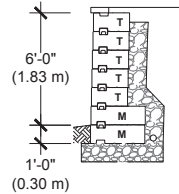

**8 ft (2.44 m) Total Height**  
T: 1  
M: 7

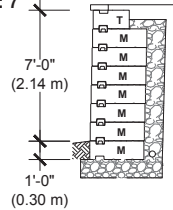

**9 ft (2.74 m) Total Height**  
T: 1  
M: 7  
B: 1

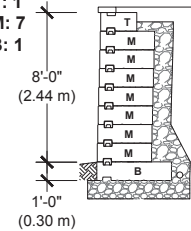

**10 ft (3.05 m) Total Height**  
M: 7  
B: 3

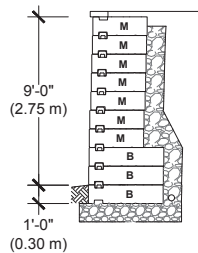

**11 ft (3.35 m) Total Height**  
M: 3  
B: 8

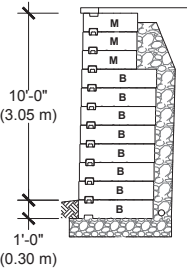

**12 ft (3.66 m) Total Height**  
M: 3  
B: 8  
BE: 1

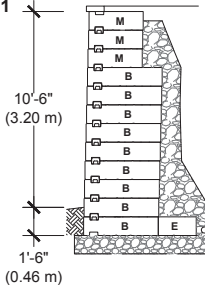

**13 ft (3.96 m) Total Height**  
M: 3  
B: 8  
BE: 2

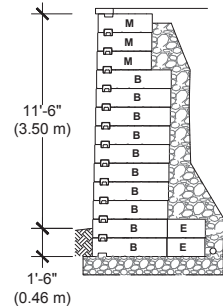

VISIT [WWW.TECHO-BLOC.COM](http://WWW.TECHO-BLOC.COM) FOR COMPLETE DESIGN CHART DOCUMENT  
(USA AND CANADA VERSIONS)

**14 ft (4.27 m) Total Height**  
M: 3  
B: 8  
BE: 3

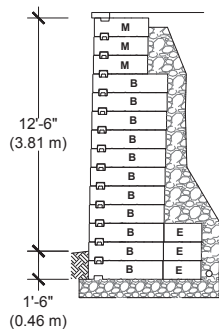

**15 ft (4.57 m) Total**  
B: 12  
BE: 3

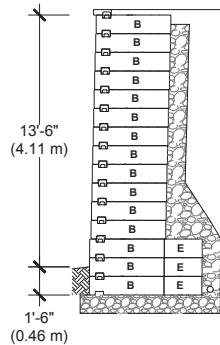

**16 ft (4.88 m) Total Height**  
B: 9  
BE: 7

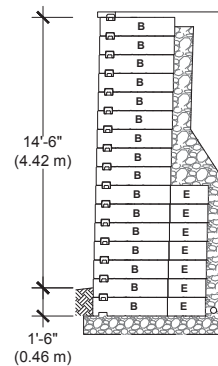

**17 ft (5.18 m) Total Height**  
B: 5  
BE: 12

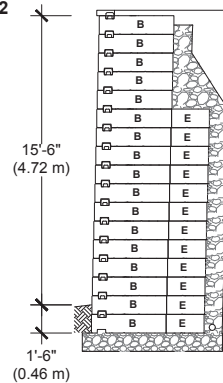

- The information contained in the design charts is supplied for information purposes only and as such should only be used for preliminary designs.
- The height (H) of the wall does not include the thickness of the cap.
- Soil parameters: retained soil ( $\phi=34^\circ$ ,  $\gamma = 130$  pcf); foundation soil ( $\phi=34^\circ$ ,  $\gamma = 120$  pcf)
- A qualified engineer should be consulted for the final design to be used for construction.
- The foundation soil must be able to support the wall system. The bearing capacity of the foundation soil, settlement, and global stability must be verified and validated by a qualified geotechnical engineer.
- The seismic analysis is not included.
- The design charts do not apply to tiered walls.
- The charts assume that the walls are constructed in accordance with Techo-Bloc specifications, good construction practice and an adequate drainage system.
- Engineering judgement should be used when interpolating between heights.
- Techo-Bloc and its predecessors, successors, beneficiaries, employees, associates, administrators and insurers accepts no liability for the incorrect use of information contained in the design charts.
- For further information, please contact our technical service department.

#### LEGEND :

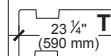

**TOP UNIT**

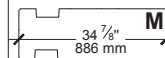

**MIDDLE UNIT**

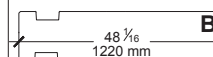

**BASE UNIT**

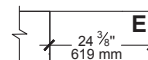

**EXTENDER UNIT**

# INSTALLATION GUIDE

## CAVITY INFILL - SKYSCRAPER

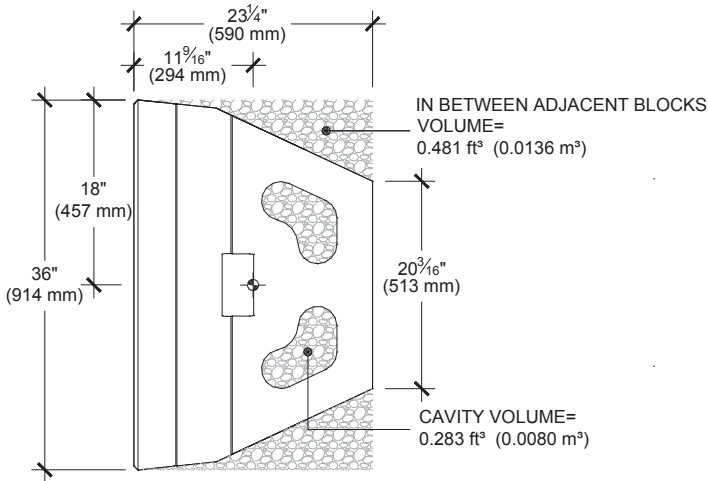

### SKYSCRAPER TOP

AGGREGATE INFILL QUANTITY	PER UNIT	±1.53 ft³	(±0.043 m³)
		±147.91 lb	(±66.65 kg)
PER WALL AREA		±0.51 ft²/ft²	(±0.16 m³/m²)
		±49.37 lb/ft²	(±248 kg/m²)

\*Assumed aggregate unit weight of 96.8 lb/ft³ (1550 kg/m³)

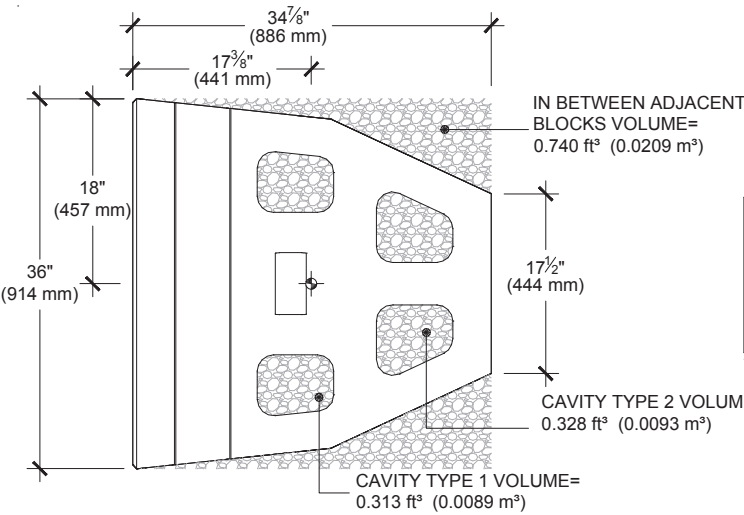

### SKYSCRAPER MIDDLE

AGGREGATE INFILL QUANTITY	PER UNIT	±2.76 ft³	(±0.078 m³)
		±267.17 lb	(±120.9 kg)
PER WALL AREA		±0.92 ft²/ft²	(±0.28 m³/m²)
		±89.06 lb/ft²	(±434 kg/m²)

\*Assumed aggregate unit weight of 96.8 lb/ft³ (1550 kg/m³)

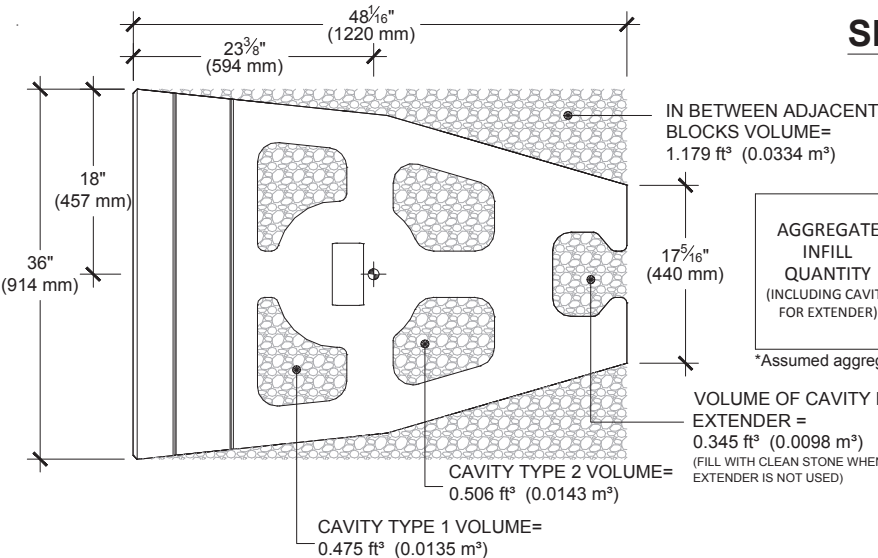

### SKYSCRAPER BASE

AGGREGATE INFILL QUANTITY (INCLUDING CAVITY FOR EXTENDER)	PER UNIT	±4.67 ft³	(±0.132 m³)
		±452.06 lb	(±204.6 kg)
PER WALL AREA		±1.56 ft²/ft²	(±0.47 m³/m²)
		±151.01 lb/ft²	(±728.5 kg/m²)

\*Assumed aggregate unit weight of 96.8 lb/ft³ (1550 kg/m³)

VOLUME OF CAVITY FOR EXTENDER = 0.345 ft³ (0.0098 m³)  
(FILL WITH CLEAN STONE WHEN EXTENDER IS NOT USED)

# INSTALLATION GUIDE

## CAVITY INFILL - SKYSCRAPER

### SKYSCRAPER BASE + EXTENDER(S)

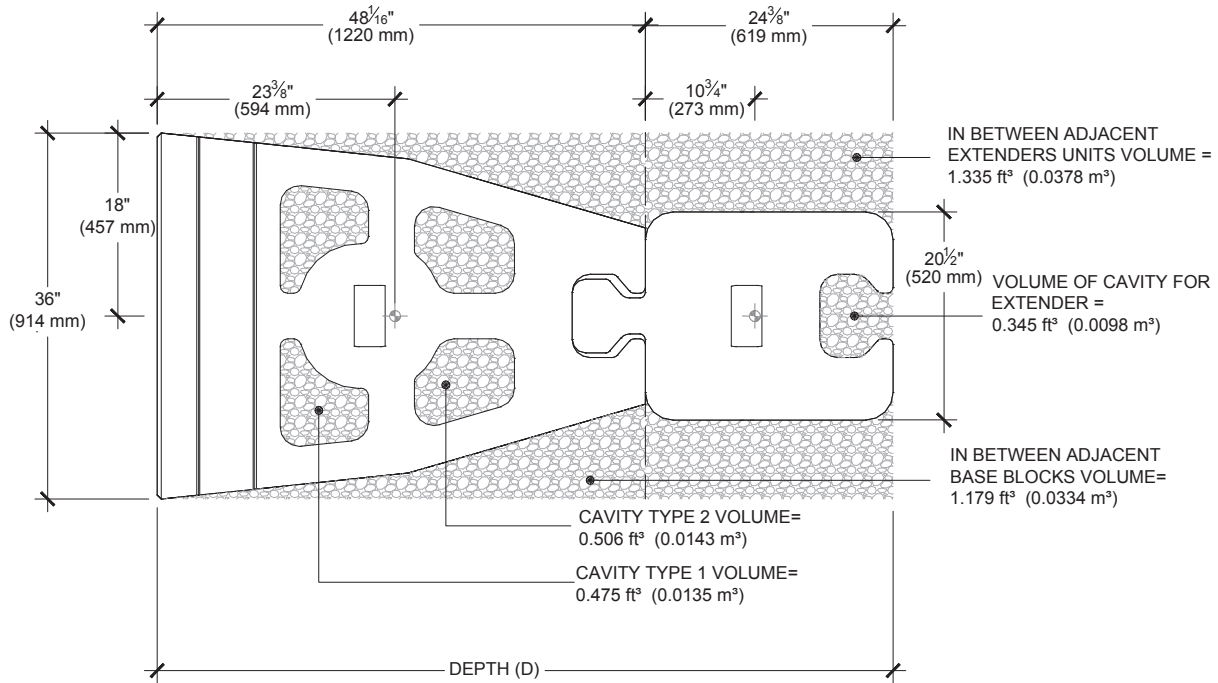

### Aggregate Infill Quantity (INCLUDING CAVITY FOR EXTENDER)

# OF EXTENDERS	DEPTH (D)		PER UNIT			PER WALL AREA				
1	72 3/8 "	1839 mm	±7.35 ft <sup>3</sup>	(±0.208 m <sup>3</sup> )	±711 lb	(±322 kg)	±2.45 ft <sup>3</sup> /ft <sup>2</sup>	(± 0.75 m <sup>3</sup> /m <sup>2</sup> )	±237 lb/ft <sup>2</sup>	(±1163 kg/m <sup>2</sup> )
2	96 3/4 "	2458 mm	±10.02 ft <sup>3</sup>	(±0.283 m <sup>3</sup> )	±970 lb	(±439 kg)	±3.34 ft <sup>3</sup> /ft <sup>2</sup>	(± 1.02 m <sup>3</sup> /m <sup>2</sup> )	±323 lb/ft <sup>2</sup>	(±1581 kg/m <sup>2</sup> )
3	121 1/8 "	3077 mm	±12.69 ft <sup>3</sup>	(±0.359 m <sup>3</sup> )	±1228 lb	(±556 kg)	±4.23 ft <sup>3</sup> /ft <sup>2</sup>	(± 1.29 m <sup>3</sup> /m <sup>2</sup> )	±409 lb/ft <sup>2</sup>	(±2000 kg/m <sup>2</sup> )
4	145 1/2 "	3696 mm	±15.36 ft <sup>3</sup>	(±0.435 m <sup>3</sup> )	±1487 lb	(±674 kg)	±5.12 ft <sup>3</sup> /ft <sup>2</sup>	(± 1.56 m <sup>3</sup> /m <sup>2</sup> )	±496 lb/ft <sup>2</sup>	(±2418 kg/m <sup>2</sup> )
5	169 7/8 "	4315 mm	±18.03 ft <sup>3</sup>	(±0.510 m <sup>3</sup> )	±1745 lb	(±791 kg)	±6.01 ft <sup>3</sup> /ft <sup>2</sup>	(± 1.83 m <sup>3</sup> /m <sup>2</sup> )	±582 lb/ft <sup>2</sup>	(±2837 kg/m <sup>2</sup> )
6	194 1/4 "	4934 mm	±20.70 ft <sup>3</sup>	(±0.586 m <sup>3</sup> )	±2004 lb	(±908 kg)	±6.9 ft <sup>3</sup> /ft <sup>2</sup>	(± 2.1 m <sup>3</sup> /m <sup>2</sup> )	±668 lb/ft <sup>2</sup>	(±3255 kg/m <sup>2</sup> )

\*Assumed aggregate unit weight of 96.8 lb/ft<sup>3</sup> (1550 kg/m<sup>3</sup>)

# INSTALLATION GUIDE

## GRAVITY WALLS - SKYSCRAPER

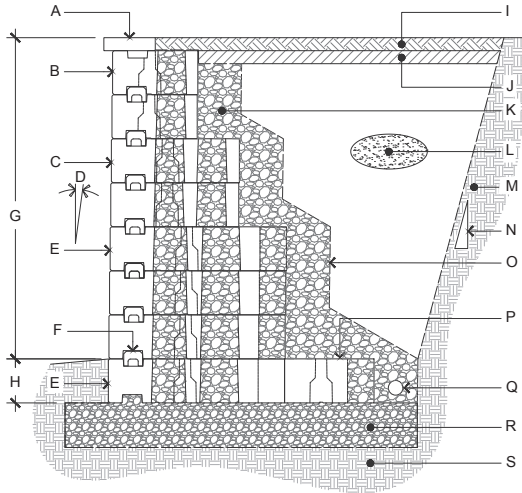

**GRAVITY NEAR VERTICAL WALL DETAIL**

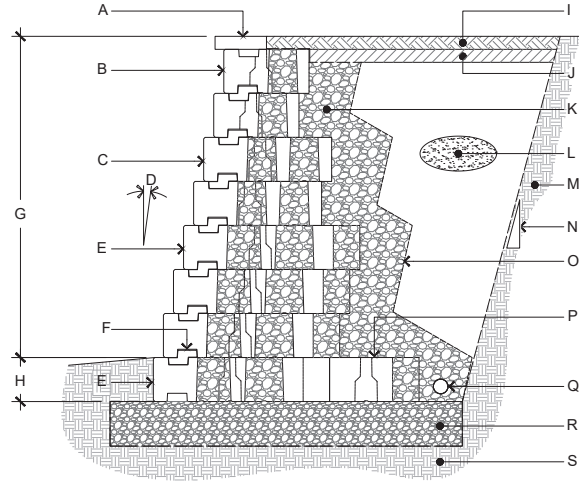

**GRAVITY NEAR INCLINED WALL DETAIL**

**A.** CAP FROM TECHO-BLOC

**B.** SKYSCRAPER TOP UNIT FROM TECHO-BLOC

**C.** SKYSCRAPER MIDDLE UNIT FROM TECHO-BLOC

**D.** WALL INCLINATION: 0.8° (NEAR VERTICAL)  
12.7° (INCLINED)

**E.** SKYSCRAPER BASE UNIT FROM TECHO-BLOC

**F.** PRECAST CONCRETE "U" CONNECTOR

**G.** EXPOSED HEIGHT

**H.** EMBEDMENT DEPTH

**I.** TOP SOIL

**J.** LOW PERMEABILITY SOIL

**K.** ¾" (20 mm) CLEAN STONE, 12" (300 mm) THICK MIN

**L.** COMPACTED BACKFILL

**M.** RETAINED SOIL

**N.** EXCAVATION ACCORDING TO LOCAL SAFETY  
REGULATIONS

**O.** GEOTEXTILE

**P.** SKYSCRAPER EXTENDER UNIT FROM TECHO-BLOC

**Q.** PERFORATED DRAIN

**R.** LEVELING PAD

**S.** FOUNDATION SOIL